

Electronic user's guide released subject to "Nokia User's Guides Terms and Conditions, 7th June, 1998"

User's Guide



9360316

Issue 2

DECLARATION OF CONFORMITY

We, NOKIA CORPORATION declare under our sole responsibility that the product NHM-7 is in conformity with the provisions of the following Council Directive: 1999/5/EC.

A copy of the Declaration of Conformity can be found from http://www.nokia.com/phones/declaration_of_conformity/.

Copyright © Nokia Corporation 2001, 2002. All rights reserved.

Reproduction, transfer, distribution or storage of part or all of the contents in this document in any form without the prior written permission of Nokia is prohibited.

Nokia and Nokia Connecting People are registered trademarks of Nokia Corporation. Other product and company names mentioned herein may be trademarks or tradenames of their respective owners.

Nokia Xpress-on and Nokia tune are trademarks of Nokia Corporation.

US Patent No 5818437 and other pending patents. T9 text input software Copyright (C) 1997-2002. Tegic Communications, Inc. All rights reserved.



Includes RSA BSAFE cryptographic or security protocol software from RSA Security.

Nokia operates a policy of continuous development. Nokia reserves the right to make changes and improvements to any of the products described in this document without prior notice.

Under no circumstances shall Nokia be responsible for any loss of data or income or any special, incidental, consequential or indirect damages howsoever caused.

The contents of this document are provided "as is". Except as required by applicable law, no warranties of any kind, either express or implied, including, but not limited to, the implied warranties of merchantability and fitness for a particular purpose, are made in relation to the accuracy, reliability or contents of this document. Nokia reserves the right to revise this document or withdraw it at any time without prior notice.

The availability of particular accessories may vary by region. Please check with the Nokia dealer nearest to you. Please dispose of batteries properly.

9360316 / Issue 2

Contents

Contents	4
FOR YOUR SAFETY	10
General information	13
Stickers in the sales package	13
Access codes	13
Overview of the functions in the phone	15
GPRS (General Packet Radio Service)	15
HSCSD (High Speed Circuit Switched Data)	16
WAP (Wireless Application Protocol)	16
Radio	17
Voice features	17
1. Your phone	18
Keys and connectors	18
Standby mode	19
2. Getting started	21
Installing the SIM card and the battery	21
Charging the battery	24
Switching the phone on and off	24
Keypad lock (Keyguard)	25
Changing the covers	27
3. Call functions	29
Making a call	29
Speed dialling a phone number	31

Making a conference call.....	31
Answering or rejecting an incoming call	32
Call waiting.....	32
Options during a call.....	32
4. Writing text	34
Setting predictive text input on or off.....	34
Using predictive text input.....	34
Writing compound words.....	36
Using traditional text input	36
Tips for writing text.....	36
5. Phone book (Names)	38
Selecting the phone book settings.....	38
Saving names and phone numbers (Add name).....	39
Saving multiple numbers and text items per name.....	39
Changing the default number	40
Searching for a name in the phone book.....	40
Editing a name, number or text item.....	41
Erasing names and numbers.....	41
Copying phone books.....	41
Sending and receiving a business card.....	42
Speed dialling.....	43
Voice dialling.....	43
Adding a voice tag	44
Making a call by using a voice tag.....	44
Replaying, changing or erasing a voice tag	45
Service numbers	45
Caller groups	45

6. Using the menu.....	47
Accessing a menu function.....	47
List of menu functions	48
7. Menu functions.....	50
Messages (Menu 1).....	50
Writing and sending messages.....	50
Options for sending a message.....	51
Text and picture templates.....	51
Inserting a text template or a picture into a message	52
Reading and replying to a message.....	52
Inbox and outbox folders.....	53
Erasing the messages.....	53
Archive folder and my folders	54
Voice messages.....	54
Info messages.....	55
Service command editor.....	55
Message settings.....	55
Call register (Menu 2).....	56
Recent calls lists.....	56
Call counters and call timers.....	57
Profiles (Menu 3)	58
Settings (Menu 4).....	59
Alarm clock	59
Time settings	60
Clock.....	60
Auto update of date and time	60
Call settings.....	60
Call divert.....	60

Anykey answer	61
Automatic redial	61
Speed dialling	61
Call waiting service	61
Summary after call	62
My number sending	62
Line for outgoing calls	62
Phone settings	62
Language	62
Cell info display	63
Welcome note	63
Network selection	63
Confirm SIM service actions	63
Help text activation	63
Start-up tone	64
Tone settings	64
Accessory settings	65
GPRS modem settings	65
Security settings	66
Restore factory settings	67
Games (Menu 5)	67
Starting a game and game options	67
Game services and game settings	68
Calculator (Menu 6)	69
Making a currency conversion	69
To-do list (Menu 7)	70
Calendar (Menu 8)	71
Making a calendar note	71
When the phone alarms for a note	72

Infrared (Menu 9)	72
Radio (Menu 10)	73
Tuning a radio channel	74
Using the radio	75
Extras (Menu 11)	76
Voice recorder	76
Recording	76
List of recordings	77
Voice commands	77
Countdown timer	78
Stopwatch	78
Time observation and time splitting	78
Lap times	79
Viewing and erasing times	79
Mobile Internet services, WAP (Menu 12)	80
Basic steps for accessing and using WAP services	80
Setting up the phone for a WAP service	80
Saving the service settings received as a text message	81
Keying in the service settings manually	81
Settings when GSM data is the selected data bearer	82
Settings when GPRS is the selected data bearer	83
Making a connection to a WAP service	83
Browsing the pages of a WAP service	85
General guidelines for using the phone keys	85
Ending a WAP connection	86
Appearance settings of WAP browser	86
Download settings	87
Bookmarks	87
Receiving a bookmark	88

Service inbox.....	88
To set the phone to receive service messages	89
The cache memory	89
Authority certificates	90
Viewing the list of authority certificates	90
Security indicator.....	90
SIM services (Menu 13).....	91
8. Data and fax communication	92
Communication applications and modem drivers	92
PC Suite	92
Modem setup.....	94
GPRS - General Packet Radio Service	94
HSCSD - High Speed Circuit Switched Data	94
Using data communication applications.....	94
9. Battery statements	96
Charging and Discharging	96
CARE AND MAINTENANCE	98
IMPORTANT SAFETY INFORMATION	99

FOR YOUR SAFETY

Read these simple guidelines. Breaking the rules may be dangerous or illegal. Further detailed information is given in this manual.



Do not switch the phone on when wireless phone use is prohibited or when it may cause interference or danger.



ROAD SAFETY COMES FIRST

Don't use a hand-held phone while driving.



INTERFERENCE

All wireless phones may get interference, which could affect performance.



SWITCH OFF IN HOSPITALS

Follow any regulations or rules. Switch the phone off near medical equipment.



SWITCH OFF IN AIRCRAFT

Wireless devices can cause interference in aircraft.



SWITCH OFF WHEN REFUELLING

Don't use the phone at a refuelling point. Don't use near fuel or chemicals.



SWITCH OFF NEAR BLASTING

Don't use the phone where blasting is in progress. Observe restrictions, and follow any regulations or rules.

**USE SENSIBLY**

Use only in the normal position. Don't touch the antenna unnecessarily.

**QUALIFIED SERVICE**

Only qualified personnel may install or repair phone equipment.

**ACCESSORIES AND BATTERIES**

Use only approved accessories and batteries. Do not connect incompatible products.

**CONNECTING TO OTHER DEVICES**

When connecting to any other device, read its user's guide for detailed safety instructions. Do not connect incompatible products.

**BACKUP COPIES**

Remember to make backup copies of all important data.

**WATER-RESISTANCE**

Your phone is not water-resistant. Keep it dry.

**CALLING**

Ensure the phone is switched on and in service. Enter the phone number, including the area code, then press . To end a call, press . To answer a call, press .

**EMERGENCY CALLS**

Ensure the phone is switched on and in service. Press as many times as needed (e.g. to exit a call, to exit a menu, etc.) to clear the display. Enter the emergency number, then press . Give your location. Do not end the call until told to do so.

■ Network Services

The wireless phone described in this guide is approved for use on the EGSM 900 and GSM 1800 network.

Dualband is a network dependent feature. Check with your local service provider if you can subscribe to and use this feature.

A number of features included in this guide are called Network Services. These are special services that you arrange through your wireless service provider. Before you can take advantage of any of these Network Services, you must subscribe to them through your service provider and obtain instructions for their use from your service provider.



Note: Some networks may not support all language-dependent characters and/or services.

■ About accessories

Check the model number of any charger before use with this device. This device is intended for use when supplied with power from ACP-7, ACP-8 and LCH-9.



Warning: Use only batteries, chargers and accessories approved by the phone manufacturer for use with this particular phone model. The use of any other types may invalidate any approval or warranty applying to the phone, and may be dangerous.

For availability of approved accessories, please check with your dealer.

When you disconnect the power cord of any accessory, grasp and pull the plug, not the cord.

General information

■ Stickers in the sales package

The stickers contain important information for services and customer support purposes.

Attach the **B** sticker to your warranty card.

Attach the **A** sticker to the Nokia Club Invitation Card supplied in the sales package.

■ Access codes

- **Security code (5 digits):** The security code protects your phone against unauthorised use, and is supplied with the phone. The preset code is 12345. Change the code in the *Settings* menu, see Security settings on page 66. Keep the new code secret and in a safe place separate from your phone.

Set the phone to request the code, see Security settings on page 66.

- **PIN code (4 to 8 digits):** The PIN (Personal Identification Number) code protects your SIM card against unauthorised use. The PIN code is usually supplied with the SIM card.
Set the phone to request the PIN code each time the phone is switched on, see Security settings on page 66.
- **PIN2 code (4 to 8 digits):** The PIN2 code may be supplied with the SIM card and is required to access some functions, such as charging unit counters.
- **PUK and PUK2 codes (8 digits):** The PUK (Personal Unblocking Key) code is required to change a blocked PIN code. The PUK2 code is required to change a blocked PIN2 code.

If the codes are not supplied with the SIM card, contact your local service provider for the codes.

- **Barring password:** The barring password is needed when using the [Call barring service](#), see Security settings on page 66. You can obtain the password from your service provider.

Overview of the functions in the phone

The Nokia 8310 phone provides many functions which are very handy for daily use, such as Calendar, Clock, Alarm clock, Countdown timer, Calculator, Games, and many more.

Also a range of Nokia Xpress-on™ colour covers is available for your phone. To change the covers, see Changing the covers on page 27.

■ GPRS (General Packet Radio Service)

GPRS is a technology that allows mobile phones to be used for sending and receiving data over the mobile network. GPRS as such is a data bearer that enables wireless access to data networks like the Internet. The applications that use GPRS are WAP, SMS messaging and the GPRS dial-up (for example, Internet and e-mail).

Before you can use GPRS technology

- You need to subscribe to the GPRS service.

For availability and subscription to GPRS service, contact your network operator or service provider.

- You need to save the GPRS settings for each of the applications used over GPRS.

See Setting up the phone for a WAP service on page 80.

See Message settings on page 55.

See GPRS modem settings on page 65 and Data and fax communication on page 92.

Pricing for GPRS and applications

Both the active GPRS connection and the applications used over GPRS, for example using WAP services, sending and receiving data and SMS messages, are priced. For more detailed information on pricing, contact your network operator or service provider.

■ HSCSD (High Speed Circuit Switched Data)

The phone enables you to use GSM high-speed data services. You can use high-speed functionality when your phone is connected to a computer via an IR connection, and when the modem drivers supporting high-speed data software are installed on your computer and selected as an active modem.

For availability and subscription to high-speed data services, contact your network operator or service provider.

See also Data and fax communication on page 92.

■ WAP (Wireless Application Protocol)

You can access various WAP services such as banking, news, weather reports and flight times. These services are specially designed for mobile phones and they are maintained by WAP service providers.

Check the availability of WAP services, pricing and tariffs with your network operator and/or the service provider whose service you wish to use. Service providers will also give you instructions on how to use their services.

See Mobile Internet services, WAP (Menu 12) on page 80.

■ Radio

Your phone has an integrated FM radio. You can listen to the radio by using a headset. See Radio (Menu 10) on page 73.

■ Voice features

Your phone offers you the following voice features:

- Voice dialling - to make a call by using a voice tag, see Voice dialling on page 43.
- Voice commands - to activate certain functions in your phone that are listed in the [Voice commands](#) menu, see Voice commands on page 77.
- Voice recorder - to make voice recordings, see Voice recorder on page 76.

1. Your phone

■ Keys and connectors

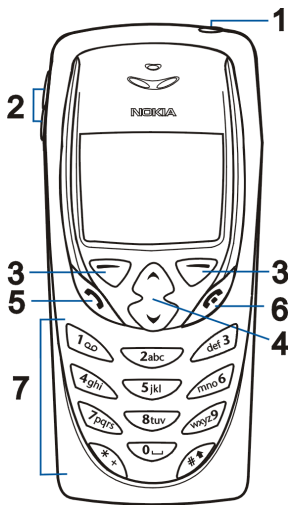

1. Power key,

Switches the phone on and off.

While in the phone book or in menu functions, or when the keypad is locked, pressing the power key briefly turns the phone's display lights on for approximately 15 seconds.

2. Volume keys

The upper key increases and the lower key decreases the earpiece (and headset) volume.

3. Selection keys, and

The function of the keys depends on the guiding text shown on the display above the keys, for example **Menu** and **Names** in standby mode.



4. Scroll keys, and



Enables scrolling through names, phone numbers, menus or settings.

5. dials a phone number, and answers a call. In standby mode

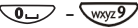
it shows the most recently called number.

6. ends an active call. Exits from any function.

7.  -  enter numbers and characters. Pressing and holding  calls your voice mailbox.

 and  are used for various purposes in different functions.

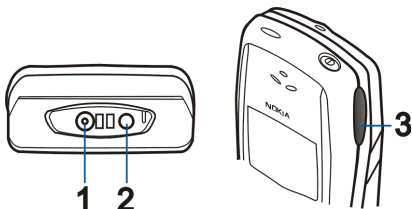

1 - Charger connector

2 - Headset connector

3 - Infrared (IR) port

■ Standby mode

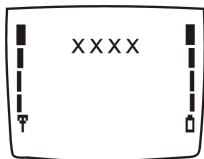

When the phone is ready for use, and no characters have been entered by the user, the phone is in standby mode.













Selection keys in standby mode are [Menu](#) and [Names](#).

xxxxIndicates in which cellular network the phone is currently being used.

 Shows the signal strength of the cellular network at your current location. The higher the bar, the stronger the signal.

 Shows the battery charge level. The higher the bar, the more power in the battery.

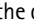
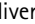
Other essential indicators in standby mode:

-  You have received one or several text or picture messages. See Reading and replying to a message on page 52.
-  You have received one or several voice messages. See Voice messages on page 54.
-  The phone's keypad is locked. See Keypad lock (Keyguard) on page 25.
-  The phone does not ring at an incoming call or text message when *Incoming call alert* is set to *Off* and *Message alert tone* is set to *Off*. See Tone settings on page 64.
-  The alarm clock is set to *On*. See Alarm clock on page 59.
-  The countdown timer is running. See Countdown timer on page 78.
-  The stopwatch timing is running in the background. See Stopwatch on page 78.
-  A GPRS dial-up connection is established, refer to GPRS modem settings on page 65. The indicator is shown on the top left of the display.
-  There is an incoming or outgoing call during a GPRS dial-up connection. The GPRS connection is suspended.
-  All your calls are diverted to another number, *Divert all voice calls*. If you have two phone lines, the divert indicator for the first line is  and for the second line . See Call divert on page 60.
-  Calls are limited to a closed user group (network service). See Security settings on page 66.

2. Getting started

■ Installing the SIM card and the battery

- Keep all miniature SIM cards out of the reach of small children.
 - The SIM card and its contacts can easily be damaged by scratches or bending, so be careful when handling, inserting or removing the card.
 - Before installing the SIM card, always make sure that the phone is switched off and then remove the battery.
1. With the back of the phone facing you, press the back cover release button (1) and slide the back cover off the phone (2).

Remove the battery by lifting it from the finger grip (3).

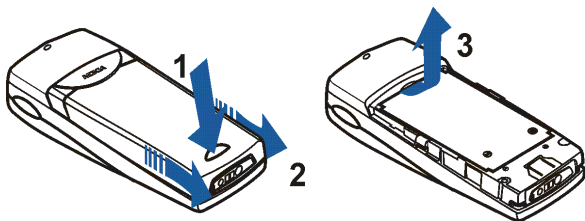

2. To release the SIM card holder, slightly lift the front edge of the cover on the card holder (4) and slide it backwards (5). Open the cover (6).

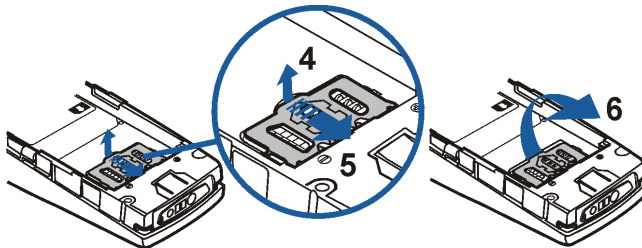

3. Insert the SIM card into the SIM card holder (7). Make sure that the SIM card is inserted properly and that the golden contact area on the card is facing downwards.

Close the cover of the SIM card holder (8).

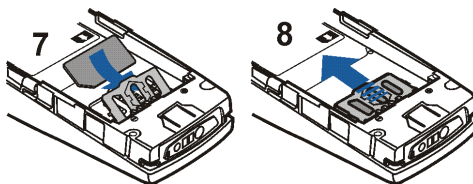

4. Replace the battery (9).

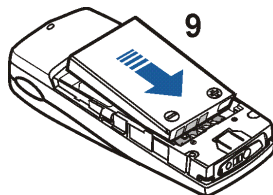

Getting started

5. Direct the back cover towards the locking catches on the front cover (10) and slide the back cover until it locks into its place (11).

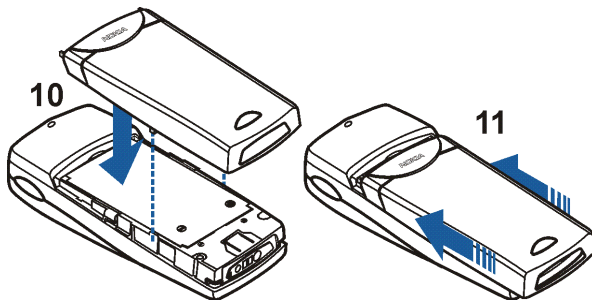

■ Charging the battery

1. Connect the lead from the charger to the socket on the bottom of your phone.
2. Connect the charger to an AC wall socket.

The text *Charging* is displayed briefly if the phone is switched on. If the battery is completely flat, it may take a few minutes before the charging indicator appears on the display or any calls can be made.

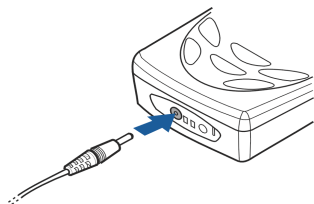

You can use the phone while the charger is connected.

The charging time depends on the charger and the battery used. For example, charging a BLB-2 battery with the ACP-7 charger takes about three hours.

■ Switching the phone on and off

Press and hold the power key .

Note that if the phone displays *Insert SIM* even though the SIM card is properly inserted, or *SIM card not supported*, contact your network operator or service provider. Your phone does not support 5 Volt SIM cards and the card may need to be changed.

- If the phone asks for a PIN code, key in the PIN code (displayed as ****), and press **OK**.

See also *PIN code request* in Security settings on page 66 and Access codes on page 13.

- If the phone asks for a security code, key in the security code (displayed as ****), and press **OK**.



See also Access codes on page 13.



Warning: Do not switch the phone on when wireless phone use is prohibited or when it may cause interference or danger.

TIPS ON EFFICIENT OPERATION: Your phone has a built-in antenna. As with any other radio transmitting device, do not touch the antenna unnecessarily when the phone is switched on. Contact with the antenna affects call quality and may cause the phone to operate at a higher power level than otherwise needed. Not touching the antenna area during a phone call optimises the antenna performance and the talktime of your phone.

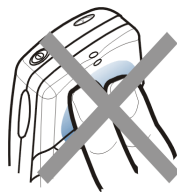

■ Keypad lock (Keyguard)

You can lock the keypad to prevent the keys being accidentally pressed, for example, when your phone is in your pocket or purse.

- **Locking the keypad**

In standby mode, press **Menu** and then  within 1.5 seconds to lock the keypad.

- **Unlocking the keypad**

Press **Unlock** and then  within 1.5 seconds to unlock the keypad.

To answer a call when the keyguard is on, press . During a call, the phone can be operated normally. When you end or reject the call, the keypad will automatically be locked.

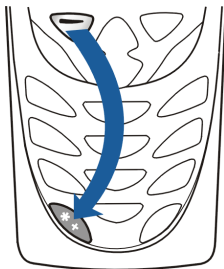



Note: When Keyguard is on, calls may be possible to the emergency number programmed into your phone (e.g. 112 or other official emergency number). Key in the emergency number and press . The number is displayed only after you have keyed in its last digit.

■ Changing the covers

Before changing the cover, always switch off the power and disconnect the phone from the charger or any other device. Always store and use the phone with the covers attached.

1. Remove the back cover of the phone. With the back of the phone facing you, press the back cover release button and slide the cover off the phone. See *Installing the SIM card and the battery on page 21*.
2. Gently pull the phone off the front cover starting from the bottom of the phone (1).
3. Replace the key mat on the new front cover (2).

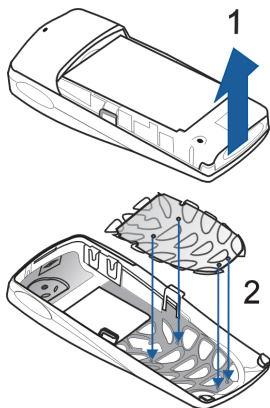

4. To replace the front cover, align the top of the phone with the top of the front cover (3) and gently push the phone towards the cover (4). Ensure that the front cover is closed into place.
5. Replace the back cover of the phone. Direct the back cover towards the locking catches on the front cover and slide the back cover until it locks into place. See Installing the SIM card and the battery on page 21.

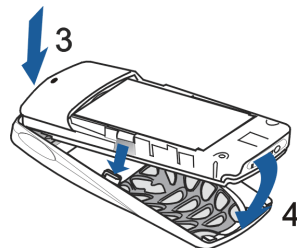

3. Call functions

■ Making a call

1. Key in the phone number, including the area code. To delete a character to the left of the cursor, press **Clear**.
For international calls, press twice for the international prefix (the + character replaces the international access code) and then key in the country code, area code and the phone number.
2. Press to call the number.
3. Press or **End call** to end the call or to cancel the call attempt.

When you are using the phone with the Plug-in Handsfree Car Kit, PPH-1, switch from handsfree mode to privacy mode by disconnecting the PPH-1 from the phone. To switch back to handsfree, plug the PPH-1 into the phone.

Making a call using the phone book

- See Searching for a name in the phone book on page 40. Press to call the number on the display.

Last number redialling



- In standby mode, press once to access the list of the 20 numbers you last called or attempted to call. Scroll to the number or name you want, and press to call the number.

Calling your voice mailbox

- In standby mode, press and hold , or press and .

If the phone asks for the voice mailbox number, key it in and press **OK**. See also Voice messages on page 54.

Speed dialling a phone number

Assign a phone number to one of the speed dialling keys, from  to , see Speed dialling on page 43. Call the number in either of the following ways:



- Press the speed dialling key you want and then press .
- If *Speed dialling* is set to on, press and hold a speed dialling key until the call is started. See Speed dialling on page 61.

Making a conference call

Conference calling is a network service that allows up to six persons to take part in a conference call.

1. Make a call to the first participant.
2. To make a call to a new participant, press **Options** and select *New call*.
3. Key in, or retrieve from the memory, the phone number of the new participant and press **Call**. The first call is put on hold.
4. When the new call has been answered, join the first participant in the conference call. Press **Options** and select *Conference*.
5. To add a new participant to the call, repeat steps 2 to 4.
6. To have a private conversation with one of the participants:
Press **Options** and select *Private*. Scroll to the desired participant and press **OK**. Rejoin the conference call, as described in step 4.
7. To end the conference call, press .

■ Answering or rejecting an incoming call

Press  to answer the incoming call and press  to end the call.

Press  to reject the incoming call.



If you press **Silence**, only the ringing tone is muted. Then either answer or reject the call.

If the headset HDD-1 or HDC-5 is connected to the phone, you can answer and end a call by pressing the headset key.



Tip: If the *Divert if busy* function is activated to divert the calls, for example to your voice mailbox, rejecting an incoming call will also divert the call. See Call divert on page 60.

Call waiting

During a call, press  to answer the waiting call. The first call is put on hold. Press  to end the active call.

To activate the *Call waiting service* function, see Call waiting service on page 61.

■ Options during a call

Many of the options that you can use during a call, are network services. Press **Options** during a call for some of the following options:





Mute or *Unmute*, *End call*, *End all calls*, *Phone book*, *Menu* and *Hold* or *Unhold*, *New call*, *Conference*, *Private*, *Answer* and *Reject*.

Send DTMF is used to send DTMF tone strings, for example, passwords or bank account numbers. Key in the DTMF string or search for it in the phone book and press **OK**. Note that you can key in the wait character w and the pause character p by repeatedly pressing .

Swap is used to switch between the active call and the call on hold, *Transfer* to connect a call on hold to an active call, and disconnect yourself from the calls, and *Record* to start the voice recording.

4. Writing text

You can key in text, for example when writing messages, in two different ways, using the traditional method, or another method called predictive text input.

When you are writing text, the predictive text input is indicated by  and the traditional text input by  at the top left of the display. The character case is indicated by **Abc**, **abc**, or **ABC** next to the text input indicator, and you can change the character case by pressing . The number mode is indicated by **123**, and you can change between the letter and number mode by pressing and holding .

■ Setting predictive text input on or off

When writing text, press **Options** and select *Dictionary*.



- To set the predictive text input on, select a language in the dictionary options list. Predictive text input is only available for the languages on the list.
- To change back to the traditional text input, select *Dictionary off*.







Tip: To quickly set the predictive text input on or off when writing text, press  twice, or press and hold **Options**.

■ Using predictive text input

You can key in any letter with a single keypress. The predictive text input is based on a built-in dictionary to which you can also add new words.

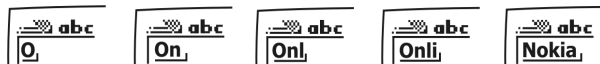

1. Start writing a word by using the keys  to . Press each key only once for one letter. The word changes after each keystroke.

For example, to write **Nokia** when the English dictionary is selected, press  once for N,  once for o,  once for k,  once for i and  once for a:



To insert a number while in letter mode, press and hold the desired number key.

More instructions for writing text, see [Tips for writing text](#) on page 36.

2. When you have finished writing the word and it is correct, confirm it by pressing  or adding a space with .



If the word is not correct, you have the following options:

- Press  repeatedly until the word you want appears and confirm it.
- Press **Options** and select *Matches*.



If the ? character is displayed after the word, the word you intended to write is not in the dictionary. To add the word to the dictionary, press **Spell**, key in the word (traditional text input is used) and press **Save**. When the dictionary becomes full, the new word replaces the oldest one that was added.

3. Start writing the next word.



Writing compound words

Key in the first part of the word and confirm it by pressing . Write the last part of the word and confirm it by pressing  or .

Using traditional text input

Press a number key,  to , repeatedly until the character you want appears. Not all characters available under a number key are printed on the key. The characters available depend on the language selected in the *Language* menu, see Language on page 62.



To insert a number while in letter mode, press and hold the desired number key.







- If the next letter you want is located on the same key as the present one, wait until the cursor appears, or press  or  and then key in the letter.
- The most common punctuation marks and special characters are available under the number key .

More instructions for writing text, see Tips for writing text on page 36.

Tips for writing text

You can use also the following keys for writing text:

- To insert a space, press .
- To move the cursor to the right or left, press  or , respectively.
- To delete a character to the left of the cursor, press **Clear**. Press and hold **Clear** to delete the characters more quickly.

- To insert a special character when using traditional text input, press , or when using the predictive text input, press and hold , or press **Options** and select *Insert symbol*. Scroll through the list of characters and press **Use** to select a character. To scroll through the list more quickly, press , ,  or , and press  to select a character.
- To insert a number while in letter mode, press **Options** and select *Insert number*. Key in the numbers you want and press **OK**.
- To insert a name or a phone number by searching for it in the phone book, press **Options** and select *Insert name* or *Insert number*.
- To insert a word when using predictive text input, press **Options** and select *Insert word*. Write the word using the traditional text input and press **Save**. The word is also added to the dictionary.

5. Phone book (Names)

You can save names and phone numbers in the phone's memory (internal phone book) or in the SIM card's memory (SIM phone book).

- The internal phone book may save up to 500 names with numbers and textual notes for each name. The total amount of names that can be saved depends on the length of the names, numbers and text items.
- The phone supports SIM cards that can save up to 250 names and phone numbers. Names and numbers saved in the SIM card's memory, are indicated by .

■ Selecting the phone book settings

1. Press **Names** and select *Settings*.
2. Select *Memory in use*, and select one of the following options:
 - Phone and SIM* to recall names and numbers from both phone books. The names and numbers will be saved in the phone's memory.
 - Phone* to use the internal phone book.
 - SIM card* to use the SIM card's phone book.
3. Select *Phone book view* and select one of the following options:
 - Name list* to show three names at a time.
 - Name and no.* to show one name and phone number at a time.
 - Large font* to show only the name.

4. Select *Memory status*. Select *Phone* or *SIM card* to see how many names and phone numbers are currently saved and how many can still be saved in the selected phone book.

■ Saving names and phone numbers (Add name)

Names and numbers will be saved in the used memory, see Selecting the phone book settings above.

1. Press **Names** and select *Add name*.
2. Key in the name and press **OK**. See Writing text on page 34.
3. Key in the phone number, and press **OK**. To key in the numbers, see Making a call on page 29.
4. When the name and number are saved, press **Done**.



Tip: Quick save









In standby mode, key in the phone number. Press **Options**, and select *Save*. Key in the name and press **OK**.

Saving multiple numbers and text items per name



You can save up to five phone numbers and four brief text items in the phone's internal phone book per name. Text items relating to a name can be street and e-mail addresses, a note and a web address.

The first number saved under a name is automatically set as the default number and is indicated with . When you select a name from the phone book, for example to make a call, the default number is used unless you select another number.

1. Make sure that the memory in use is either *Phone* or *Phone and SIM*. See Selecting the phone book settings on page 38.
2. To access the list of names and phone numbers, press or in standby mode.

3. Scroll to the name saved in the phone's internal phone book to which you want to add a new number or text item, and press **Details**.
4. Press **Options** and select *Add number* or *Add text*.
5. Select one of the following number or text types:
 -  **General** is the default type used when no other number type is set as the default number. Other number types are  *Mobile*,  *Home*,  *Office* and  *Fax*.
 - Text types are  *E-mail*,  *Web addr.*,  *Postal addr.* and  *Note*.To change the number or text type, select *Change type* in the options list.
6. Key in the number or text item and press **OK** to save it.
7. Press **Back** and then **Exit** to return to standby mode.



Changing the default number

Press  or  in standby mode, scroll to the name you want and press **Details**. Scroll to the number you want to set as the default number. Press **Options** and select *Set as default*.

■ Searching for a name in the phone book

1. Press **Names** and select *Search*.
2. Either press **List** to access the phone book or key in the first character(s) of the name you are searching for and press **Search**. The matches with the pop-up window appear.
3. Scroll to the name you want, and press **Details**. Scroll to view the details of the selected name.



Tip: To quickly find a name and phone number, press  or  in standby mode. Key in the first letter(s) of the name, and/or scroll to the name you want.

■ Editing a name, number or text item

Search for the name (and number) you want to edit and press **Details**. Scroll to the name, number or text item you want to edit, and press **Options**. Select *Edit name*, *Edit number*, or *Edit text*, and edit the name, number, or text and press **OK**.

■ Erasing names and numbers

Press **Names** and select *Erase*.

- To delete names and numbers one by one, select *One by one* and scroll to the name (and number) you want to delete. Press **Erase** and press **OK** to confirm.
- To delete names and numbers in the phone book all at once, select *Erase all* and then scroll to the phone book, *Phone* or *SIM card* and press **Erase**. Press **OK** and confirm with the security code.

■ Copying phone books

You can copy names and phone numbers from the phone's memory to your SIM card's memory and vice versa.

1. Press **Names** and select *Copy*.
2. Select the copying direction, *From phone to SIM card* or *From SIM card to phone*.
3. Select *One by one*, *All* or *Default nos.*
 - If you select *One by one*, scroll to the name you want to copy and press **Copy**. *Default nos.* is shown if you copy from the phone to the SIM card. Only the default numbers will be copied.

- To select whether you want to keep or erase the original names and numbers, choose *Keep original* or *Move original*.
 - If you select *All* or *Default nos.*, press **OK** when *Start copying?* or *Start moving?* is displayed.

■ Sending and receiving a business card

You can send and receive a person's contact information as a business card either via IR or as an Over The Air (OTA) message if supported by the network.

- **Receiving a business card**

Make sure that your phone is ready to receive data through its IR port, see Infrared (Menu 9) on page 72. The user of the other phone can now send the name and phone number via Infrared.

When you have received a business card via IR or as an OTA message, press **Show**. Press **Options** and select *Save* to save the business card in the phone's memory, or *Discard* to discard the received business card.

- **Sending a business card**

Using your phone's infrared (IR) port, you can send a person's contact info as a business card to a compatible phone or other handheld device which supports the vCard standard.

- Search for the name and phone number you want to send from the phone book, press **Options** and select *Send bus. card*.
- To send the business card via IR, make sure that the other phone or the PC is set up to receive data via its IR port and select *Via infrared*.

To send the business card as an OTA message, select *Via SMS*.

■ Speed dialling

To make a call by using the speed dialling keys, see Speed dialling a phone number on page 31.

Assigning a number to a speed dialling key

Press **Names** and select *Speed dials*. Scroll to the speed dialling key number you want, and press **Assign**. If a number is already assigned to the key, press **Options**, and you can view, change or erase the assigned number.

Press **Search**, and select first the name and then the number you want to assign.

■ Voice dialling

You can make a phone call by saying a voice tag that has been added to a phone number. Any spoken word(s), such as a person's name(s), can be a voice tag.

Before using voice dialling, note that:

- Voice tags are not language dependent. They are dependent on the speaker's voice.
- Voice tags are sensitive to background noise. Record them and make calls in a quiet environment.
- When recording a voice tag or making a call by saying a voice tag, hold the phone in the normal position near to your ear.
- Very short names are not accepted. Use long names and avoid similar names for different numbers.





Note: You must say the name exactly as you said it when you recorded it. This may be difficult in, for example, a noisy environment or during an emergency, so you should not rely solely upon voice dialling in all circumstances.

Adding a voice tag

Save or copy in the phone's memory the names and phone numbers, to which you want to add a voice tag. You can add up to ten voice tags.

You can also add voice tags to the names in the SIM card, but if you replace your SIM card with a new one, you first need to delete the old voice tags before you can add new ones.

1. In standby mode, press  or .
2. Scroll to the name to which you want to add a voice tag and press **Details**. Scroll to the phone number you want and press **Options**.
3. Select *Add voice tag*.
4. Press **Start**, and say clearly the word(s) you want to record as a voice tag. After recording, the phone plays the recorded tag.
5. When the voice tag has been successfully saved, *Voice tag saved* is displayed, a beep sounds and a symbol  appears after the phone number with a voice tag.

Making a call by using a voice tag

When an application using the GPRS connection is sending or receiving data, you cannot make a call by using voice dialling. To make a call by using a voice tag, end the application using the GPRS connection.

1. In standby mode, press and hold the volume down key, or press and hold **Names**. A short tone is heard and *Speak now* is displayed.
2. Say the voice tag clearly.

- The phone plays the recognised voice tag and then dials the phone number of the voice tag after 1.5 seconds.

If you are using the headset HDD-1 or HDC-5, press and hold the headset key to start the voice dialling.

Replaying, changing or erasing a voice tag

Press **Names** and select *Voice tags*. Scroll to the name with the voice tag you want, press **Options** and you can listen to, erase or change the recorded voice tags.

■ Service numbers

You can call the service numbers of your service provider if the numbers are included on your SIM card.

Press **Names** and select *Service nos.*. Scroll to a service number and press  to call the number.

■ Caller groups

You can arrange the names and phone numbers saved in the phone book into caller groups. For each caller group, you can set the phone to sound a specific ringing tone and show a selected graphic on the display when you receive a call from a phone number in the group, see below. To set the phone to ring only upon calls from phone numbers belonging to a selected caller group, see *Alert for* in Tone settings on page 64.

Press **Names**, select *Caller groups* and select the caller group you want. Select

- Group name*, key in a new name for the caller group and press **OK**.
- Group ringing tone* and select the ringing tone you want to set for the group. *Default* is the ringing tone selected for the currently active profile.

- *Group logo* and select *On* to set the phone to display the group logo, *Off* not to display it, *View* to view the logo, or *Send logo* to send the logo as an Over The Air (OTA) message if supported by your network.
- *Group members*. To add a name to the caller group, (press *Options* and) select *Add name*. Scroll to the name you want to add to the group and press *Add*.
To remove a name from a caller group, scroll to the name you want to remove, and press *Options* and select *Remove name*.

6. Using the menu

The phone offers you an extensive range of functions which are grouped in menus. Most of the menu functions are provided with a brief help text. To view the help text, scroll to the menu function you want and wait for 15 seconds. To exit the help text, press **Back**. See Help text activation on page 63.

■ Accessing a menu function





By scrolling

1. To access the menu, press **Menu**.
2. Scroll through the menu and select, for example, *Settings* by pressing **Select**.
3. If the menu contains submenus, select the one you want, for example *Call settings*.
4. If the selected submenu contains further submenus, repeat step 3. Select the next submenu, for example *Anykey answer*.
5. Select the setting of your choice.
6. Press **Back** to return to the previous menu level, and **Exit** to exit the menu.

By shortcut

The menus, submenus and setting options are numbered and you can access them by using their shortcut number. The shortcut number is shown in the top right corner of the display.

- To access the menu, press **Menu**. Key in quickly, within two seconds, the index number of the menu function you want to access.

For example, to set the *Anykey answer On*, press **Menu**, , ,  and .

List of menu functions

1. Messages

1. Write message
2. Inbox
3. Outbox
4. Archive
5. Templates
6. My folders
7. Erase messages
8. Voice messages
9. Info messages
10. Service command editor
11. Message settings



2. Call register

1. Missed calls
2. Received calls
3. Dialed numbers
4. Erase recent call lists
5. Call duration
6. Call costs
7. GPRS data counter
8. GPRS connection timer



3. Profiles

1. General
2. Silent
3. Meeting
4. Outdoor
5. Pager



4. Settings

1. Alarm clock
2. Time settings
3. Call settings
4. Phone settings
5. Tone settings
6. Accessory settings
7. GPRS modem settings
8. Security settings
9. Restore factory settings



5. Games

1. Select game
2. Game services
3. Settings



6. Calculator



7. To-do list

8. Calendar

9. Infrared

10. Radio

11. Extras

1. Voice recorder
2. Voice commands
3. Countdown timer



4. Stopwatch

12. Services

1. Home
2. Bookmarks
3. Service inbox
4. Settings
5. Go to address
6. Clear the cache

13. SIM services¹



1. Only shown if supported by your SIM card. The name and contents vary depending on the SIM card

7. Menu functions

■ Messages (Menu 1)



You can read, write and send text and picture messages or save your messages. All the messages in your phone's message memory are organised in folders.

Before you can send any text or picture messages, you need to save your message centre number, see Message settings on page 55.

Writing and sending messages

You can write and edit text messages of up to 160 characters.

1. Press **Menu**, select *Messages* and *Write message*
2. Key in a message. See Writing text on page 34.

See also Inserting a text template or a picture into a message on page 52.

3. To send the message, press **Options**, and select *Send*.
4. Enter the recipient's phone number or search for the phone number in the phone book.

Press **OK** to send the message.



Note: When sending messages via the SMS network service, your phone may display the words "*Message sent*". This is an indication that the message has been sent by your phone to the message centre number programmed into your phone. This is not an indication that the message has been received at the intended destination. For more details about SMS services, check with your service provider.

Options for sending a message



After you have written a message, press **Options**, and select *Sending opt's*.

- To send a message to several recipients, select *Send to many*. When you have sent the message to everyone you want to send it to, press **Done**.
- To send a message using a message profile, select *Sending profile* and then the message profile you want to use.

For example, if you select a profile you have defined as an e-mail transmission, key in or search the phone book for the recipient's e-mail address and press **OK**. Key in the e-mail service number, select *Accept* to send the message.

To define a message profile, see Message settings on page 55.

Text and picture templates

Press **Menu**, select *Messages* and *Templates*. The list of text templates, indicated with , and picture templates, indicated with , is displayed.

Your phone offers you 10 picture message templates. You can also save new pictures into the *Templates* folder. More pictures can be found on the Nokia website, <http://www.club.nokia.com>.



Note: This function can be used only if it is supported by your network operator or service provider. Only phones that offer picture message features can receive and display picture messages.

- Each picture message is made up of several text messages. Therefore, sending one picture message may cost more than sending one text message.
- Since picture messages are saved in the phone's memory, you cannot view them if you use your SIM card with another phone.

Inserting a text template or a picture into a message

When you are writing or replying to a message, press **Options**.

- Select *Use template* and select the template you want to insert.
- When you are writing or replying to a message, press **Options**. Select *Attach picture* and select a picture to view it. Press **Attach** to insert the picture into your message. The  indicator on the header of the message indicates that a picture has been attached. The number of characters that you can enter in a message, depends on the size of the picture.

To view the text and the picture together before sending the message, press **Options** and select *Preview*.



Reading and replying to a message

When you have received a message, the  indicator and the number of new messages followed by *message(s) received* will appear on the display.

The blinking  indicates that the message memory is full. Before you can receive or send new messages, delete some of your old messages.

1. Press **Show** to view the message, or press **Exit** to view it later.

Reading the message later: Press **Menu**, select *Messages* and *Inbox*.

2. If more than one message is received, select the message you want to read. An unread text message is indicated by  in front of it and an unviewed picture message is indicated by .
3. While reading or viewing the message, press **Options**.

You can select an option to erase, forward, edit, move, and rename the message you are reading. You can also change the font size of the message. Select *Copy to calend.* to copy the message to your phone's calendar as a reminder note for the current day.

Select *Details* to view, for example, the sender's name and phone number, the message centre used, reception date and time.

Select *Use number* to extract numbers from the current message.

Select *Save picture* to save the picture in the *Templates* folder.

Select *Reply* to reply to a message. Select *Original text* to include the original message in the reply, or select standard answers, for example, *Thank you* or *Congrats* or *Template* to be included in the reply, or select *Empty screen*.

4. Write your reply message.
5. Press **Options**, select *Send*, and press **OK** to send the message to the displayed number.

Inbox and outbox folders

After you have read an incoming text or picture message, the phone saves the message in the *Inbox* folder of the *Messages* menu.

The messages you have saved to be sent later, are saved in the *Outbox* folder.

Erasing the messages

Press **Menu**, select *Messages* and select *Erase messages*.

To delete all the messages in a folder, scroll to the folder and press **OK**. Then press **OK** when *Erase all read messages from folder?* is displayed.

To delete all read messages from all the folders, scroll to *All read* and press **OK**. Then press **OK** when *Erase read messages from all folders?* is displayed.

Archive folder and my folders

To organise your messages, you can move some of your messages to the *Archive* folder, or add new folders for your messages.

While reading a message, press **Options**. Select *Move*, scroll to the folder where you want to move the message and press **OK**.

To add or delete a folder, press **Menu**, select *Messages* and *My folders*.

- To add a folder, press **Options** and select *Add folder*.
- To delete a folder, scroll to the folder you want to delete, press **Options** and select *Delete folder*.

Voice messages

Voice mailbox is a network service and you may need to subscribe to it first. For more information and for the voice mailbox number, contact your service provider.

Press **Menu**, select *Messages* and *Voice messages*. Select

- *Listen to voice messages* to call your voice mailbox at the phone number you have saved within the *Voice mailbox number* menu.

Each phone line may have its own voice mailbox number, see Line for outgoing calls on page 62.

- *Voice mailbox number* to key in, search for or edit your voice mailbox number and press **OK** to save it.

If supported by the network, the indicator  will indicate new voice messages. Press [Listen](#) to call your voice mailbox number.

Info messages

With the info message network service you can receive messages on various topics, for example weather or traffic conditions, from your service provider. For available topics and relevant topic numbers, contact your service provider.

If the *GPRS connection* is set to *Always online*, the info messages may not be received. In that case, set the *GPRS connection* to *When needed*, see Setting up the phone for a WAP service on page 80.

Service command editor

Press [Menu](#), select *Messages* and *Service command editor*. Key in and send service requests (also known as USSD commands) such as activation commands for network services, to your service provider.

Message settings

The message settings affect the sending of the messages.

Press [Menu](#), select *Messages* and *Message settings*.

If more than one message profile set is supported by your SIM card, select the set you want to change.

Select *Message centre number* to save the phone number of the message centre. You need the message centre number to send text and picture messages. You receive the number from your service provider.

Select *Messages sent as* to select the message format, or *Message validity*. Select *Default recipient number* to save a default number to send messages for this message profile, *Delivery reports* to request

the network to send delivery reports on your messages (network service), and *Use GPRS* to set GPRS as the preferred SMS bearer. Select *Reply via same centre* to allow the recipient of your message to send you a reply message via your message centre (network service), and *Rename sending profile* to change the name of the selected message profile. The message profile sets are displayed only if your SIM card supports more than one set.

■ Call register (Menu 2)



The phone registers the phone numbers of missed, received and dialled calls, and the approximate length and cost of your calls.

The phone registers missed and received calls only if the network supports these functions, the phone is switched on and within the network's service area.

When you press *Options* in the *Missed calls*, *Received calls* and *Dialled numbers* menu, you can view the date and the time of the call, edit or erase the phone number from the list, save the number in the phone book, or send a message to the number.

Recent calls lists

Press *Menu*, select *Call register* and then select

- *Missed calls* to view the list of the last ten phone numbers from which somebody has tried to call you (network service).



Tip: When a note about missed calls is being displayed, press *List* to access the list of phone numbers. Scroll to the number you would like to call back and press .

- *Received calls* to view the list of the last ten phone numbers from which you have most recently accepted calls (network service).
- *Dialled numbers* to view the list of the 20 phone numbers that you have most recently called or attempted to call. See also Last number redialling on page 29.
- *Erase recent call lists* to erase the recent calls lists. Select whether you want to delete all the phone numbers in the recent call lists, or only those numbers in the missed calls, received calls or dialled numbers lists. You cannot undo the operation.

Call counters and call timers



Note: The actual invoice for calls and services from your service provider may vary, depending upon network features, rounding-off for billing, taxes and so forth.

Press **Menu**, select *Call register* and then select

- *Call duration*, scroll to view the approximate duration of your incoming and outgoing calls in hours, minutes and seconds. To clear the timers, the security code is needed.

Each phone line has its own call timers and the timers of the selected line are displayed. See Line for outgoing calls on page 62.

- *Call costs* (network service). Select *Last call units* or *All calls' units* to check the cost of your last call or all calls.

Select *Call cost settings* and then select *Clear counters*, or select *Show costs in* to set the phone to show the remaining talk time in terms of charging units, *Units*, or units of currency, *Currency*.

Contact your service provider for charging unit prices. Select *Call cost limit* to limit the cost of your

calls to a certain amount of charging units or units of currency. The PIN2 code is needed for the call cost settings.



Note: When no more charging units or currency units are left, calls may only be possible to the emergency number programmed into your phone (e.g. 112 or other official emergency number).

- *GPRS data counter* and scroll to check the amounts of last sent and last received data, data sent and received in total, and to clear the counters. The counters unit is a byte.
- *GPRS connection timer* and scroll to check the duration of the last GPRS connection or the total GPRS connection. You can also clear the timers.

■ Profiles (Menu 3)



Your phone has various setting groups, profiles, for which you can customise the phone tones for different events and environments. At first, personalise the profiles to your liking and then you only need to activate a profile to use it.

Available profiles are *General*, *Silent*, *Meeting*, *Outdoor*, and *Pager*.

Press **Menu** and select *Profiles*. Scroll to a profile and press **Select**.

- To activate the profile, select *Activate*.



Tip: To change the profile quickly in standby mode, press the power key , scroll to the profile you want to activate and press **Select**.

- To set the profile to be active for a certain amount of time up to 24 hours, select *Timed* and set the time. When the time set for the profile expires, the previous profile that was not timed, becomes active.

- To personalise the profile, select *Personalise*. Select the setting you want to change and make the changes.

The settings can also be changed in the *Tone settings* menu, see Tone settings on page 64.

In addition you can rename a profile, *Profile name*. The *General* profile can not be renamed.

■ Settings (Menu 4)



Alarm clock

The alarm clock uses the time format set for the clock. The alarm clock works even when the phone is switched off.

Press **Menu**, select *Settings* and *Alarm clock*. Key in the alarm time and press **OK**. To change the time when the alarm time is set, select *On*.

When the alarm time expires

The phone will sound an alert tone, and flash *Alarm!* and the alarm time on the display.

Press **Stop** to stop the alarm. If you let the phone continue to alarm for a minute or press **Snooze**, the alarm stops for a few minutes and then resumes.

If the alarm time is reached while the phone is switched off, the phone switches itself on and starts sounding the alarm tone. If you press **Stop**, the phone asks whether you want to activate the phone for calls, *Switch the phone on?* Press **No** to switch off the phone or **Yes** to make and receive calls.

Note: Do not press **Yes** when wireless phone use is prohibited or when it may cause interference or danger.

Time settings

Clock

Press **Menu**, select *Settings*, *Time settings* and *Clock*.

Select *Show clock* and the time is shown on the top right of the display when the phone is in standby mode. Select *Set the time*, to adjust the clock to the right time, and *Time format* to select the 12-hour or 24-hour time format.

The clock also serves the functions *Messages*, *Call register*, *Alarm clock*, timed *Profiles* and *Calendar*.

If the battery is removed from the phone for a long time, you may need to set the time again.

Auto update of date and time

Press **Menu**, select *Settings*, *Time settings* and *Auto update of date and time* (network service). To set the phone to automatically update the time and date according to the current time zone, select *On*. To set the phone to ask for a confirmation before the update, select *Confirm first*.

Updating the date and time affects the alarm clock, calendar and voice recorder, and the alarm notes you have set are now set to the local time. Updating may cause some calendar notes to expire.

Call settings

Call divert



Press **Menu**, select *Settings*, *Call settings* and *Call divert* (network service). With call divert you can direct your incoming calls to another number, for example, to your voice mailbox number. For details, contact your service provider. Divert options not supported by your SIM card or your network operator may not be shown.

Select the divert option you want, for example, select *Divert if busy* to divert the voice calls when your number is busy or when you reject an incoming call.

To set the divert setting to on, select *Activate*, to set the divert setting to off, select *Cancel*, or *Check status* to check whether the divert is activated or not. To change the timeout when the call is diverted, first select *Set delay* if this is available for the divert option, and then select *Activate* to set the divert setting to on. Several divert options may be active at the same time.

To see the divert indicators in standby mode, see Standby mode on page 19.



Anykey answer

Press *Menu*, select *Settings*, *Call settings* and then *Anykey answer*. Select *On* and you can answer an incoming call by briefly pressing any key, except , selection keys  and , and .

Automatic redial

Press *Menu*, select *Settings*, *Call settings* and *Automatic redial*. Select *On* and your phone will make a maximum of ten attempts to connect the call after an unsuccessful call attempt.

Speed dialling

Press *Menu*, select *Settings*, *Call settings* and *Speed dialling*. Select *On* and the names and phone numbers assigned to the speed dialling keys, from  to , can be dialled by pressing and holding the corresponding number key.

Call waiting service

Press *Menu*, select *Settings*, *Call settings* and *Call waiting service*. Select *Activate* and the network will notify you of an incoming call while you have a call in progress (network service). See Call waiting on page 32.

Summary after call

Press **Menu**, select **Settings**, **Call settings** and **Summary after call**. Select **On** and the phone will briefly display the duration and cost (network service) of the last call.

My number sending

Press **Menu**, select **Settings**, **Call settings** and **My number sending**. Select **On** and your phone number will be displayed to the person you are calling (network service). Select **Set by network** and the setting agreed upon with your service provider is used.



Line for outgoing calls

Line for outgoing calls is a network service to select the phone line 1 or 2, that is subscriber number, for making calls.

Press **Menu**, select **Settings**, **Call settings** and **Line for outgoing calls**. If you select **Line 2** and have not subscribed to this network service, you will not be able to make calls. However, calls on both lines can be answered regardless of the selected line.

If supported by your SIM card, you can prevent the line selection by selecting the option **Lock**.

For more information on availability, contact your network operator or service provider.

 **Tip:** In standby mode you can switch from one line to the other by pressing and holding .

Phone settings

Language

Press **Menu**, select **Settings**, **Phone settings** and **Language**. Select the language for the display texts. If **Automatic** is selected, the phone selects the language according to the information on the SIM card.

Cell info display

Press **Menu**, select *Settings*, *Phone settings* and *Cell info display*. Select *On* to set the phone to indicate when it is used in a cellular network based on Micro Cellular Network (MCN) technology.

If the *GPRS connection* is set to *Always online*, the info messages may not be received. In that case, set the *GPRS connection* to *When needed*, see Setting up the phone for a WAP service on page 80.

Welcome note

Press **Menu**, select *Settings*, *Phone settings* and *Welcome note*. Key in the note you would like to be shown briefly when the phone is switched on. To save the note, press **Options**, and select *Save*.

Network selection

Press **Menu**, select *Settings*, *Phone settings* and *Network selection*. Select *Automatic* and the phone automatically selects one of the cellular networks available in your area.

If you select *Manual*, you can select a network that has a roaming agreement with your home network operator. Otherwise, *No access* will be displayed and you must select another network. The phone stays in manual mode until the automatic mode is selected or another SIM card is inserted into the phone.

Confirm SIM service actions

See SIM services (Menu 13) on page 91.

Help text activation

To set the phone to show or not to show the help texts, press **Menu**, select *Settings*, *Phone settings* and *Help text activation*.

See also Using the menu on page 47.

Start-up tone

To set the phone to play or not to play a start-up tone when the phone is switched on, press **Menu**, select *Settings*, *Phone settings* and *Start-up tone*.

If you have set a welcome note, the start-up tone will not be played, see Welcome note on page 63.

Tone settings

Press **Menu**, select *Settings* and then *Tone settings*. You can find the same settings in the *Profiles* menu, see Profiles (Menu 3) on page 58.

Select *Incoming call alert* to select how the phone notifies you of an incoming voice call. The options are *Ring*, *Ascending*, *Ring once*, *Beep once* and *Off*.

Select *Ring*, *Ring volume* and *Vibrating alert* for an incoming voice call and an incoming message. The vibrating alert does not work when the phone is connected to a charger, desktop stand, or a car kit.



Tip: If you receive a ringing tone via IR or OTA, you can save five ringing tones at a time in the ringing tone list.

Select *Message alert tone* to set the alert tone for the incoming messages, *Keypad tones*, or *Warning tones* to set the phone to sound tones for example, when the battery is running out of power.

Select *Alert for* to set the phone to ring only upon calls from phone numbers that belong to a selected caller group. Scroll to the caller group you want or *All calls* and press **Mark**.

Accessory settings

Accessory settings menu is shown only if the phone is or has been connected to one of the following accessories: headsets HDC-5, HDE-2 or HDD-1, handsfree car kit PPH-1, or mobile inductive loopset LPS-3.

Press **Menu**, select *Settings* and *Accessory settings*. Select *Headset*, *Handsfree* or *Loopset*.

- Select *Default profile* to select the profile you want to be automatically activated when you connect the selected accessory. You can select another profile while the accessory is connected.
- Select *Automatic answer* to set the phone to answer an incoming call automatically after five seconds. If the *Incoming call alert* is set to *Beep once* or *Off*, automatic answer will not be in use.
- Select *Lights* to set the lights permanently on, *On*. Select *Automatic* to set the lights on for 15 seconds after a keypress. The *Lights* option is available only when *Handsfree* is selected.
- Select *Use loopset* to set the loopset in use instead of the headset, *Yes*. *Use loopset* is available only when *Loopset* is selected.

GPRS modem settings

You can connect the phone via infrared connection to a compatible PC and use the phone as a modem to enable GPRS connectivity from the PC.

Press **Menu**, select *Settings* and *GPRS modem settings*. Select *Active access point* and activate the access point you want to use. Select *Edit active access point* to change the access point settings.

- Scroll to *Alias for access point* and press **Rename**. Key in the name you would like for the activated access point and press **OK**.
- Scroll to *GPRS access point* and press **Edit**. Key in the Access Point Name (APN) and press **OK**.

An access point name is needed to establish a connection to a GPRS network. You can obtain the Access Point Name from your network operator or service provider.

You can also set the GPRS dial-up service settings (Access Point Name) on your PC by using the Nokia Modem Options software, see Modem setup on page 94. If you have set the settings on your PC and your phone, note that the settings set on the PC will be used.

Security settings



Note: When security features that restrict calls are in use (call barring, closed user group and fixed dialling), calls may be possible to certain emergency numbers in some networks (e.g. 112 or other official emergency numbers).

Press **Menu**, select *Settings* and *Security settings*. Select

- *PIN code request* to set the phone to ask for your PIN code every time the phone is switched on. Some SIM cards do not allow the PIN code request to be turned off.
- *Call barring service* (network service) to restrict incoming calls to and outgoing calls from your phone. A barring password is required.
- *Fixed dialling* to restrict your outgoing calls to selected phone numbers if this function is supported by your SIM card. The PIN2 code is required.
- *Closed user group*. Closed user group is a network service that specifies the group of people whom you can call and who can call you. For more information contact your network operator or service provider.
- *Security level*. Select *Phone* and the phone will ask for the security code whenever a new SIM card is inserted into the phone.

Select *Memory* and the phone will ask for the security code when SIM card's memory is selected and you want to change the memory in use, see *Selecting the phone book settings* on page 38 or *copy from one memory to another, Copying phone books* on page 41.

- *Change of access codes* and you can change the security code, PIN code, PIN2 code or barring password. Codes can only include numbers from 0 to 9.

Note that you should avoid using access codes similar to the emergency numbers, such as 112, to prevent accidental dialling of the emergency number.

Restore factory settings

To reset some of the menu settings to their original values, press *Menu*, select *Settings* and *Restore factory settings*. Key in the security code and press *OK*. For example, the names and phone numbers saved in the phone book are not deleted.

■ Games (Menu 5)



Note: Your phone must be switched on to use this function. Do not switch the phone on when wireless phone use is prohibited or when it may cause interference or danger.

Starting a game and game options

Press *Menu*, select *Games* and *Select game*. Select the game you would like to play, *Snake II*, *Bumper* or *Pairs II*. If available for the game, select the game type or *1 player* or *2 players*.

- You may play some games as a 2-player game via the IR port of your phone with a person who has the same game on a compatible phone. Before starting a 2-player game, ensure that the IR ports of the two phones are pointing at each other. See *Infrared (Menu 9)* on page 72.

Select one of the options that may be available for the game:

- *Continue* to continue a paused game. To pause a game, press  or either of the selection keys.
- *New game* to start a new game session in 1-player games.
- *Host game* to start a game against another person in 2-player game.
- *Join game* to join a game in 2-player game.
- *Options* to change the settings for the selected game.
- *Level* to set the level of difficulty for the selected game.
- *High scores* to view the highest scores.
- *Instructions* to select a help text on how to play the game.

Game services and game settings

Press *Menu*, and select *Games*. Select

- *Game services* and the phone tries to connect to the WAP pages of Club Nokia by using the currently active set of service settings.

If the connection fails, you may not be able to access Club Nokia from the WAP service whose connection settings are currently active. In this case, enter the *Services* menu, activate another set of service settings, see Making a connection to a WAP service on page 83. Try again to connect to Club Nokia.

For the availability of different WAP services, pricing and tariffs, contact your network operator and/or the WAP service provider.

- *Settings* to set sounds, lights and vibrator, *Shakes*, for the game. The vibrator can be set on only if *Vibrating alert* is set on, see Tone settings on page 64. You can save your Club Nokia membership

number, *Club Nokia ID*. For more information on Club Nokia and the game services, visit www.club.nokia.com. Availability may vary by country.

■ Calculator (Menu 6)



The calculator in your phone adds, subtracts, multiplies, divides, counts the square and the square root and converts currency values.



Note: Your phone must be switched on to use this function. Do not switch the phone on when wireless phone use is prohibited or when it may cause interference or danger.

This calculator has a limited accuracy and rounding errors may occur, especially in long divisions.

1. Press **Menu** and select *Calculator*.
2. When '0' is displayed on the screen, key in the first number in the calculation, press  for a decimal point.
3. Press **Options** and select *Add, Subtract, Multiply, Divide, Square, Square root* or *Change sign*.



Tip: Alternatively, press  once to add, twice to subtract, three times to multiply or four times to divide.

4. Key in the second number.
5. For a total, press **Options** and select *Equals*. Repeat steps 3 to 5 as many times as is necessary.
6. To start a new calculation, first press and hold **Clear**.

Making a currency conversion

1. Press **Menu** and select *Calculator*.

2. To save the exchange rate, press **Options** and select *Exchange rate*. Select either of the displayed options. Key in the exchange rate, press  for a decimal point, and press **OK**. The exchange rate remains in the memory until you replace it with another one.
3. To make the currency conversion, key in the amount to be converted, press **Options** and select *In domestic* or *In foreign*.

You can also make the currency conversion in standby mode. Key in the amount to be converted, press **Options** and select *In domestic* or *In foreign*.

■ To-do list (Menu 7)



You can save a note for a task that you have to do. The notes can be saved in priority order. You may be able to save up to 30 notes but this depends on how long the notes are.

Press **Menu** and select *To-do list*. Press **Options**, or scroll to the note you want and then press **Options**.

- Select *Add* to add a new note. Key in the subject for the note, press **Options** and select *Save*. Select the priority for the note, *High (1)*, *Medium (2)*, or *Low (3)*. The notes are listed first in priority order and then in alphabetical order.

Dictionary, refer to Setting predictive text input on or off on page 34.

- You can also erase, edit, view the selected note, or edit the priority level of the selected note, and you can select the priority level from which you like to view notes, save the note as a calendar note or send the note to another phone as a text message.

■ Calendar (Menu 8)



The calendar helps you to keep track of reminders, calls that you need to make, meetings, and birthdays.



Note: Your phone must be switched on to use this function. Do not switch the phone on when wireless phone use is prohibited or when it may cause interference or danger.

Press **Menu** and select **Calendar**. Scroll to the day you want. If there are any notes set for the day, the corresponding note type indicator is shown.

Day view and note view

- Press **Options** and select **Day notes**. The day view lists the notes made for the day. The note indicator is shown first on the line.
- When in the Day view, scroll to the note you want to view. Press **Options** and select **View**.
The note view allows you to view the details of the selected note. You can scroll through the note.





The other options for the calendar views may include:

- Options for making a note, for sending a note via IR, or as a note directly to another phone's calendar or as a text message.
- Options for erasing, editing, moving and repeating a note and for copying a note to another day.
- **Settings** to set, for example, the date, time, date format or time format. In the **Auto erase** option you can set the phone to delete old notes automatically after a specified time. However, the repeat notes, for example, birthday notes, will not be deleted.

Making a calendar note



For keying in letters and numbers, see *Writing text* on page 34.

Press **Menu** and select *Calendar*. Scroll to the date you want, press **Options** and select *Make a note*. Select one of the following note types:

-  *Meeting* - Key in the note, or search for the name in the phone book, and press **OK**. Then key in the time for the meeting and press **OK**. If you wish, select *Alarm on* and then the alarm time for the note.
-  *Call* - Key in the phone number you want, press **OK**, and key in the name and press **OK**, or search for them in the phone book. Then key in the time for the call and press **OK**. If you wish, select *Alarm on* and then the alarm time for the note.
-  *Birthday* - Key in the persons name (or search for it in the phone book), and press **OK**. Then key in the date of birth, and press **OK**. Key in the year of birth (optional), and press **OK**. If you key in the year, the note shows you the person's age after the name. If you wish, select *Alarm on* and then the alarm time for the note.
-  *Memo* - Key in the note, and press **OK**.

When a tone alert is set, the indicator  is displayed when you view the notes.

When the phone alarms for a note

The phone beeps, and displays the note. With a call note  on the display, you can call the displayed number by pressing . To stop the alarm and view the note, press **View**. To stop the alarm without viewing the note, press **Exit**.

■ Infrared (Menu 9)

You can set up the phone to receive data through its infrared (IR) port. To use an IR connection, the device with which you want to establish a connection must be IrDA



compliant. You can send or receive data such as business cards and calendar notes to or from a compatible phone or data device (for example, a computer) via the IR port of your phone.

Do not point the IR (infrared) beam at anyone's eye or allow it to interfere with other IR devices. This device is a Class 1 Laser product.





Note: Your phone must be switched on to use this function. Do not switch the phone on when wireless phone use is prohibited or when it may cause interference or danger.

Sending and receiving data via IR

- Ensure that the IR ports of the sending and receiving devices are pointing at each other and that there are no obstructions between the devices. The preferable distance between the two devices in an infrared connection is one meter at most.
- To activate the IR port of your phone to receive data via IR, press **Menu** and select *Infrared*.
- The user of the sending phone selects the desired IR function to start data transfer.

If data transfer is not started within two minutes after the activation of the IR port, the connection is cancelled and has to be started again.

IR connection indicator

- When  is shown continuously, the IR connection is activated and your phone is ready to send or receive data via its IR port.
- When  blinks, your phone is trying to connect to the other device or a connection has been lost.

■ Radio (Menu 10)



Note: Your phone must be switched on to use this function. Do not switch the phone on when wireless phone use is prohibited or when it may cause interference or danger.

You can listen to the FM radio on your phone only by using the headsets HDD-1, HDC-5 or HDE-2. Connect the headset to the headset connector on the bottom of the phone. The lead of the headset functions as the antenna of the radio, so let it hang freely.



Note that the quality of the radio broadcast depends on the radio station's coverage in that particular area.

1. To turn on the radio, press **Menu** and select **Radio**. On the display are
 - Channel location number and the name of the radio channel.
 - Frequency of the radio channel.
2. If you have already saved radio channels, you can scroll to the channel you would like to listen to, or select a radio channel location 1 to 9 by pressing the corresponding number key.
When using the headset HDD-1 or HDC-5, press the headset key to select a radio channel.
3. When the radio is on, press **Options** and select **Switch off** to turn off the radio.



Tip: To quickly turn off the radio, press and hold .

Tuning a radio channel

When the radio is on, press and hold  or  to start the channel search. Searching stops when a channel is found. To save the channel, press **Options**, and select **Save channel**. Key in the name of the channel and press **OK**. Select the location where you want to save the channel.



Tip: To quickly save the channel in a location 1 to 9, press and hold the corresponding number key, then key in the name of the channel and press **OK**.

Using the radio

When the radio is on, press **Options** and select

- **Switch off** to turn off the radio.
- **Save channel** to save the radio channel you have found, refer to Tuning a radio channel above. Up to 20 radio channels can be saved.
- **Auto tuning.** Briefly press either of the scroll keys to start the channel search upwards or downwards. The search stops when a channel has been found, press **OK**. To save the channel, see **Save channel** above.
- **Set frequency.** If you know the frequency of the radio channel you would like to listen to (between 87.5 MHz and 108.0 MHz), key it in and press **OK**. To save the channel, see **Save channel** above.



Tip: To quickly select **Set frequency**, press  when in the **Radio** menu.

- **Rename.** Key in a new name for the saved channel and press **OK**.
- **Manual tuning.** Briefly press either of the scroll keys to move the channel search 0.1 MHz upwards or downwards or press and hold down for searching the channel fast upwards or downwards. To save the found channel, press **OK** and see **Save channel** above.



Tip: To quickly select **Manual tuning**, press  when in the **Radio** menu.

You can normally answer an incoming call while listening to the radio. The volume of the radio is muted. When you end the call, the radio will automatically be turned on.

When an application using a GPRS or HSCSD connection is sending or receiving data, it may interfere with the radio.

■ Extras (Menu 11)



Note: Your phone must be switched on to use the functions in *Extras* menu. Do not switch the phone on when wireless phone use is prohibited or when it may cause interference or danger.

Voice recorder

You can record pieces of speech, sound or an active call for three minutes. For example, this is useful when recording a name and phone number for writing them down later.



Note: Obey all local laws governing recording of calls. Do not use this feature illegally.

Recording

1. Press **Menu**, select *Extras* and *Voice recorder*.
2. To start the recording, select *Record*. To start the recording during a call, press **Options**, and select *Record*. While recording a call, all parties to the call will hear a faint beep sound approximately every five seconds.

When recording, hold the phone in the normal position near to your ear.

3. To end the recording, press **Stop**.
4. Key in a new name for the recording and press **OK** to save it.
If you do not want to save the recording, press **Clear** to erase the preset name. Then press **Back** and **OK**.

If you record an active call, the phone automatically saves the recording by name *Recording*.

List of recordings

Press **Menu**, select *Extras* and *Voice recorder*. Select *Recordings list*, scroll to the recording you want and press **Options**.

- Select *Playback* to listen to the selected recording.
- Select *Edit title*. Key in a new name for the recording and press **OK**.
- Select *Erase* to erase the recording. Press **OK** to confirm.
- Select *Add alarm*. Key in the date for the alarm and press **OK**. Key in the time for the alarm and press **OK**.

Alarm replaces *Add alarm* when the alarm is set on. Select *Alarm* and the name of the recording, the date and the time for the alarm are displayed. To remove the alarm, press **Erase** and then press **OK**.

When the alarm time expires, the phone will sound an alert tone, *Recording!* and the alarm time and the name of the recording are displayed. Press **Stop** to stop the alarm, and then press **Play** to play the recording.

Voice commands

You have a list of phone functions which can be activated by saying a voice tag. Up to five voice tags for the voice commands can be added.

Press **Menu**, select *Extras* and *Voice commands*. Select the command folder you want, scroll to the command to which you want to add a voice tag and press **Options**. If the command already has a voice tag, the indicator  is shown.

To add a voice command, refer to Adding a voice tag on page 44. See also Replaying, changing or erasing a voice tag on page 45.

To activate a voice command, refer to Making a call by using a voice tag on page 44.

When an application using the GPRS connection is sending or receiving data, you cannot activate a voice command. To activate a voice command, end the application using the GPRS connection.

Countdown timer

Press **Menu**, select *Extras* and *Countdown timer*. Key in the alarm time in hours and minutes and press **OK**. If you wish, write your own note text which is displayed when the time expires, and press **OK** to start the countdown timer.

- To change the countdown time, select *Change time*, or to stop the timer, select *Stop timer*.

If the alarm time is reached when the phone is in standby mode, the phone sounds a tone and flashes the note text if it is set or else *Countdown time up*. Stop the alarm by pressing any key. If no key is pressed, the alarm automatically stops within 30 seconds. To stop the alarm and to erase the note text, press **OK**.

Stopwatch

You can measure time, take intermediate times or lap times using the stopwatch. During timing, the other functions of the phone can be used. To set the timing in the background, press .

Using the stopwatch consumes the battery and the phone's operating time will be reduced. Be careful not to let it run in the background when performing other operations with your phone.

Time observation and time splitting

1. Press **Menu**, select *Extras*, *Stopwatch* and *Split timing*.

You can select *Continue* if you have set the timing in the background.

2. Press **Start** to start the time observation. Press **Split** every time you want to take an intermediate time. The intermediate times are listed below the running time on the display. Scroll to view the times.
3. Press **Stop** to stop the time observation.
4. Press **Options** and select
Start to start the time observation again. The new time is added to the previous time.
Save to save the time. Key in a name for the measured time and press **OK**. If no name is keyed in, the total time is used as a title.
Reset to reset the time without saving it.

Lap times

Press **Menu**, select *Extras*, *Stopwatch* and *Lap timing*. Press **Start** to start the time observation and **Lap** to take a lap time. Press **Stop** to stop the lap timing. Press **Options** and you can save or reset the lap times. Refer to Time observation and time splitting above.

Viewing and erasing times

Press **Menu**, select *Extras*, and *Stopwatch*.

If the stopwatch is not reset, you can select *Show last* to view the latest measured time. Select *View times* and a list of names or final times of the time sets is shown, select the time set you want to view.

To delete the saved times, select *Erase times*. Select *All at once* and press **OK**, or select *One by one*, scroll to the times you want to delete, press **Erase** and press **OK**.

■ Mobile Internet services, WAP (Menu 12)



See also WAP (Wireless Application Protocol) on page 16.



Note: Your phone must be switched on to use this function. Do not switch the phone on when wireless phone use is prohibited or when it may cause interference or danger.

The WAP services use Wireless Mark-Up Language (WML) on their WAP pages. Web pages using the Hyper Text Mark-Up Language (HTML) cannot be viewed on your phone.

Basic steps for accessing and using WAP services

1. Save the service settings that are needed to access the WAP service that you want to use. See Setting up the phone for a WAP service below and Appearance settings of WAP browser on page 86.
2. Make a connection to the given WAP service. See Making a connection to a WAP service on page 83.
3. Start browsing the pages of the WAP service. See Browsing the pages of a WAP service on page 85.
4. Once you are finished browsing, end the connection to the WAP service. See Ending a WAP connection on page 86.

Setting up the phone for a WAP service

You may receive the service settings as a text message from the network operator or service provider that offers the WAP service that you want to use. For more information, contact your network operator or service provider, or visit Club Nokia's Web site (www.club.nokia.com).

You can also key in the settings manually. For appropriate settings, contact your network operator or service provider. The WAP settings may be available, for example, on the Web site of the network operator or service provider.

Saving the service settings received as a text message

When you receive the service settings as a text message, *Service settings received* is displayed.

- To save and activate the received settings, press **Options** and select *Save*.
If no settings are saved in *Active service settings*, the settings are saved under the first free connection set and also activated.
- To discard the received settings, press **Options** and select *Discard*.
- To view the received settings first, press **Options** and select *View*. To save the settings, press **Save**.

Keying in the service settings manually

1. Press **Menu**, select *Services*, and *Settings*.
2. Select *Active service settings*.

You need to activate the set where you want to save the service settings. A set is a collection of settings needed for making a connection to a WAP service.

3. Scroll to the set you would like to activate and press **Activate**.
4. Select *Edit active service settings*.

Select each of the service settings one by one and key in all the required settings.

- *Settings name* - Key in the new name for the connection set and press **OK**.
- *Homepage* - Key in the homepage address of the WAP service that you want to use, press **1**  for a period, and press **OK**.
- *Session mode* - Select *Permanent* or *Temporary*.
- *Connection security* - Select *On* or *Off*.

When the connection security is *On*, the phone tries to use a secure connection with the WAP service. If a secure connection is not available, the connection will not be made. If you wish to connect anyway, with a non-secure connection, you must set the connection security to *Off*.

- *Data bearer* - Select *GSM data* or *GPRS*. Settings for the selected bearer, see Settings when GSM data is the selected data bearer and Settings when GPRS is the selected data bearer below.

For pricing, connection speed and other information, contact your network operator or service provider.

Settings when GSM data is the selected data bearer

- *Dial-up number* - Key in the phone number and press **OK**.
- *IP address* - Key in the address, press  for a period, and press **OK**. You obtain the IP address from your network operator or service provider.
- *Authentication type* - Select *Secure* or *Normal*.
- *Data call type* - Select *Analogue* or *ISDN*.
- *Data call speed* - Select the speed you want to use, or select *Automatic*. *Automatic* is available only if the current selected data call type is *Analogue*. The actual data call speed depends on the service provider.
- *Login type* - Select *Manual* or *Automatic*. If you select *Automatic*, the login type uses the user name and password keyed in the following settings. If you select *Manual*, the login information is required when establishing a connection.
- *User name* - Key in the user name and press **OK**.
- *Password* - Key in the password and press **OK**.

Settings when GPRS is the selected data bearer

- *GPRS connection* - Select *Always online* or *When needed*.

If you select *Always online*, the phone is automatically registered to a GPRS network when you switch the phone on. Starting a WAP or PC dial-up application creates the connection between phone and network and data transfer is possible. When you end the application, GPRS connection is ended but the registration to the GPRS network remains.

If you select *When needed*, the GPRS connection is established when you connect to a WAP service and closed when you end the WAP connection.

- *GPRS access point* - Key in the access point name and press **OK**.

An access point name is needed to establish a connection to a GPRS network. You obtain the access point name from your network operator or service provider.

- *IP address* - Key in the address, press  for a period, and press **OK**. You obtain the IP address from your network operator or service provider.
- *Authentication type* - Select *Secure* or *Normal*.
- *Login type* - Select *Manual* or *Automatic*. If you select *Manual* when the *GPRS connection* is set to *Always online*, the *Always online* connection will be disabled.
- *User name* - Key in the user name and press **OK**.
- *Password* - Key in the password and press **OK**.

Making a connection to a WAP service

Firstly, make sure that the service settings of the WAP service you want to use are activated. To activate the settings:

- Press **Menu**, select **Services** and **Settings**. Select **Active service settings** and scroll to the set you want to activate and press **Activate**.

Secondly, make a connection to the WAP service. There are three ways to connect:

- Open the homepage of the WAP service:

Press **Menu**, select **Services** and **Home**.



Tip: To quickly open the homepage of a WAP service:

In standby mode, press and hold .

OR

- Select a bookmark of the WAP service:

Press **Menu**, select **Services**, **Bookmarks**, and select a bookmark.

If the bookmark does not work with the current active service settings, activate another set of service settings and try again.

OR



- Key in the address of the WAP service:

Press **Menu**, select **Services** and then **Go to address**. Key in the address of the WAP service, press  for special characters, and press **OK**.







Note that it is not necessary to add the prefix `http://` in front of the address since it will be added automatically.

Browsing the pages of a WAP service

After you have made a connection to the WAP service, you can start browsing its WAP pages. The function of the phone keys may vary in different WAP services. Follow the text guides on the phone display. For more information, contact your WAP service provider.

Note that if GPRS is selected as the data bearer, the indicator  is shown on the top left of the display during browsing. If there is an incoming (or outgoing) call during a GPRS connection, the indicator  will be shown on the top right of the display. The GPRS connection is suspended.

General guidelines for using the phone keys

- Use the scroll keys  or  to browse the WAP page.
- To select a highlighted item, press .
- To enter letters and numbers, press the keys  -  and to enter special characters, press the key .
- Some or all of the following options are available while a WAP connection is in progress. Press **Options** and select the option you want.

Home - to go back to the homepage of the WAP service

Bookmarks - the list of bookmarks is displayed. For details, see Bookmarks on page 87.

Edit | Open row | Open link | Open list - to key in text or select a highlighted item on the WAP page.

Add bookmark - to add the current WAP page as a bookmark in your bookmarks list.

Go to address - to key in the address of the WAP service you want.

Service inbox - the list of service messages is displayed, see Service inbox on page 88.

Appear. sett. - for details, see Appearance settings of WAP browser on page 86.

Download settings - for details, see Download settings on page 87.

Use number - to copy a number from the current WAP page for saving or calling (and ends the WAP connection). If the WAP page contains several numbers, you may select the desired one.

Reload - to reload and update the current WAP page.

Clear the cache - for details, see The cache memory on page 89.



Security info - to view security information about the current WAP connection and the server.

Quit - to quit browsing and end the call.

The WAP browser supports functions which you can access while browsing. You can make a voice call while you are on a WAP page, send DTMF tones while a voice call is in progress, and save in the phone book a name and a phone number from a WAP page.

Ending a WAP connection

When you are using a WAP service, press **Options** and select *Quit*. When *Quit browsing?* is shown, press **Yes**.

Alternatively, press . If *GSM data* is the selected data bearer, press  twice.

The phone ends the call and terminates the connection to the WAP service.

Appearance settings of WAP browser

1. When no WAP connection is in progress

- Press **Menu**, select *Services*, *Settings* and *Appearance settings*.

When a WAP connection is in progress

- Press **Options** and select *Appear.sett.*

2. Select *Text wrapping* or *Show images*.
3. Select *On* or *Off* for *Text wrapping* and *Yes* or *No* for *Show images*.

When *Text wrapping* is set to *On*, the text continues on the next line if it cannot be shown on one line.

When *Show images* is set to *No*, any pictures appearing on the WAP page are not shown. This can speed up the browsing of WAP pages that contain a lot of pictures.

Download settings

You can set the phone to allow or prevent receiving cookies.

A cookie is data that a WAP site saves in your phone's browser cache memory. The data can be, for example, your user information or your browsing preferences. Cookies will be saved until you clear the cache memory, see The cache memory on page 89.

1. When no WAP connection is in progress
 - Press *Menu*, select *Services*, *Settings* and *Download settings*.

When a WAP connection is in progress

- Press *Options* and select *Download settings*.
2. Select *Cookies* and select *Allow* or *Reject* to allow or prevent the phone receiving cookies.

Bookmarks

You can save up to 25 WAP page addresses as bookmarks in the phone's memory.

1. When no WAP connection is in progress
 - Press *Menu*, select *Services* and then *Bookmarks*.

When a WAP connection is in progress

- Press **Options** and select *Bookmarks*.
2. Scroll to the bookmark you want to use and press **Options**.
 3. Select one of the following options:
 - Go to* to make a connection to the WAP page associated with the bookmark.
 - Edit* or *Erase* to modify or delete the selected bookmark.
 - Send* to send the selected bookmark to another phone via SMS, *Via SMS*.
 - New bookmark* to create a new bookmark without connection to the WAP service. Key in the address and the title of the WAP page and press **OK**.

Note that your phone may have some pre-installed bookmarks for sites not affiliated with Nokia. Nokia does not warrant or endorse these sites. If you choose to access them, you should take the same precautions, for security or content, as you would with any site.

Receiving a bookmark

When you have received a bookmark as an Over The Air (OTA) message, press **Options** and select *View* to view the bookmark, *Save* to save the bookmark, or *Discard* to discard it.

Service inbox

The phone is able to receive service messages (pushed messages) sent by your service provider. Service messages are notifications of, for example, news headlines, and they may contain a text message or address of a WAP service.

1. To access service inbox when no WAP connection is in progress

When you have received a service message, *1 service message received* will be displayed. Press **View** to access the *Service inbox*.

If you press **Exit** the message is moved to the *Service inbox*. To access the *Service inbox* later, press **Menu**, select *Services*, and *Service inbox*.

When a WAP connection is in progress

Press **Options** and select *Service inbox*.

2. Scroll to the message you want and press **Options**.

Select *Retrieve* to activate the WML browser and download the indicated content.

Select *Details* to display detailed information on the service notification.

Select *Erase* to delete the selected service notification.

To set the phone to receive service messages

Press **Menu**, select *Services*, *Settings*, *Service inbox settings*, and *Service messages*. To set the phone to receive service messages, select *On*. If you select *Off*, the phone will not receive service messages.

The cache memory



Note: The information or services you have accessed are stored in the cache of your phone. A cache is a buffer memory, which is used to store data temporarily. If you have tried to access or have accessed confidential information requiring passwords (for example, your bank account), empty the cache of your phone after each use.

To clear the cache memory when no WAP connection is in progress

- Press **Menu**, select *Services*, and *Clear the cache*.

To clear the cache memory when a WAP connection is in progress

- Press **Options** and select *Clear the cache*.

Authority certificates

For using some WAP services, such as banking services, you need an authority certificate. Using the certificate can help you improve the security of connections between your phone and a WAP gateway or WAP server, if the *Connection security* is set to *On*.

You can download the certificate from a WAP page if the WAP service supports the use of authority certificates. After the download, you can view the certificate and then save or delete it. If you save the certificate, it is added to the list of certificates in the phone.

You will see a note on the phone display if the identity of the WAP server or WAP gateway cannot be verified, if the WAP server or WAP gateway certificate is not authentic or if you do not have the right certificate in your phone.

Viewing the list of authority certificates

Press **Menu**, select *Services*, and *Settings*. Select *Authority certificates*.

See also *Security info* in General guidelines for using the phone keys on page 85.

Security indicator

If the security indicator  is displayed during a WAP connection, the data transmission between the phone and the WAP gateway or WAP server (identified by the *IP address* in the *Edit active service settings*) is encrypted.

However, the security indicator does not indicate that the data transmission between the gateway and the content server (place where the requested resource is stored) is secure. It is up to the service provider to secure the data transmission between the gateway and the content server.

■ SIM services (Menu 13)



In addition to the functions available on the phone, your SIM card may provide additional services that you can access in menu 13. Menu 13 is shown only if it is supported by your SIM card. The name and contents of the menu depend entirely on the service available.



Note: For availability, rates and information on using SIM services, contact your SIM card vendor, e.g. network operator, service provider or other vendor.

You can set the phone to show you the confirmation messages sent between your phone and the network when you are using the SIM services by selecting the option [Yes](#) within the menu 4-4-5, [Confirm SIM service actions](#).

Note that accessing these services may involve sending a text message (SMS) or making a phone call for which you may be charged.

8. Data and fax communication

You can transfer data to other compatible devices when your Nokia 8310 phone is connected to a compatible PC via an IR connection.

To send and receive e-mail and faxes, and to connect to computers and access the Internet, you also need the appropriate data and fax communications software installed on your computer. You can use the Nokia 8310 with a variety of commercially available data and fax communications applications.

To use your phone as a modem, you first need to install it as a modem.

■ Communication applications and modem drivers

On the Nokia website, www.forum.nokia.com, you may find the required system files for data communication and also the instructions for installation. You may also find documents that advise you on how to set up devices and applications for use with the Nokia 8310.

PC Suite

PC Suite contains applications which help you

- to conveniently manage various phone functions from your PC
- to synchronise contacts and calendar items between your phone and your PC Personal Information Manager.
- to draw and edit caller group graphics and picture messages.
- to create new ringing tones for your phone.

- to select the connection type used when connecting your PC and your phone.
- to back up and restore personal information from phone to PC or to another phone.

Modem setup

Modem setup installs the following components on your PC:

- N8310 data and fax modem adapters, which enable you to use your phone as a modem in data and fax calls.
- Nokia Modem Options software to set options for the data calls you make. You find the settings for HSCSD and GPRS here.

GPRS – General Packet Radio Service

See also GPRS modem settings on page 65.

HSCSD – High Speed Circuit Switched Data

With the GSM high-speed data service you can use the Internet and other services more quickly than usual. When sending and receiving e-mail, the 14.4 kbps data transmission speed can be doubled up to 28.8 kbps. In Internet connections a download speed of up to 43.2 kbps can be achieved if supported by the equipment of the network operator and the Internet service provider.

Note that sending data in HSCSD mode drains the phone's battery faster than normal voice or data calls as the phone is sending data faster. For continuous usage, connect the phone to a charger.

Using data communication applications

- Activate the IR connection of your phone by selecting Menu 9.
- Make sure that the infrared port of the phone faces the infrared port of the PC.
- Start using the data communications application on the PC.

For information on the use of the application, refer to the documentation for the application.

Note that making or answering phone calls during a PC connection is not recommended as it might disrupt the operation.

For better performance during data calls, place the phone on a stationary surface with the keypad facing downward. Do not move the phone by holding it in your hand during a data call.

9. Battery statements

■ Charging and Discharging

Your phone is powered by a rechargeable battery.

Note that a new battery's full performance is achieved only after two or three complete charge and discharge cycles!

The battery can be charged and discharged hundreds of times but it will eventually wear out. When the operating time (talk-time and standby time) is noticeably shorter than normal, it is time to buy a new battery.

Use only batteries approved by the phone manufacturer and recharge your battery only with the chargers approved by the manufacturer. Unplug the charger when not in use. Do not leave the battery connected to a charger for longer than a week, since overcharging may shorten its lifetime. If left unused a fully charged battery will discharge itself over time.

Temperature extremes can affect the ability of your battery to charge.

Use the battery only for its intended purpose.

Never use any charger or battery which is damaged.

Do not short-circuit the battery. Accidental short-circuiting can occur when a metallic object (coin, clip or pen) causes direct connection of the + and - terminals of the battery (metal strips on the battery) for example when you carry a spare battery in your pocket or purse. Short-circuiting the terminals may damage the battery or the connecting object.

Leaving the battery in hot or cold places, such as in a closed car in summer or winter conditions, will reduce the capacity and lifetime of the battery. Always try to keep the battery between 15°C and 25°C. A phone with a hot or cold battery may temporarily not work, even when the battery is fully charged. Batteries' performance is particularly limited in temperatures well below freezing.

Do not dispose of batteries in a fire !

Dispose of batteries according to local regulations (e.g. recycling). Do not dispose as household waste.

CARE AND MAINTENANCE

Your phone is a product of superior design and craftsmanship and should be treated with care. The suggestions below will help you to fulfil any warranty obligations and to enjoy this product for many years.

- Keep the phone and all its parts and accessories out of the reach of small children.
- Keep the phone dry. Precipitation, humidity and all types of liquids or moisture can contain minerals that will corrode electronic circuits.
- Do not use or store the phone in dusty, dirty areas. Its moving parts can be damaged.
- Do not store the phone in hot areas. High temperatures can shorten the life of electronic devices, damage batteries, and warp or melt certain plastics.
- Do not store the phone in cold areas. When it warms up (to its normal temperature), moisture can form inside, which may damage electronic circuit boards.
- Do not attempt to open the phone. Non-expert handling may damage it.
- Do not drop, knock or shake the phone. Rough handling can break internal circuit boards.
- Do not use harsh chemicals, cleaning solvents, or strong detergents to clean the phone.
- Do not paint the phone. Paint can clog the moving parts and prevent proper operation.
- Use only the supplied or an approved replacement antenna. Unauthorised antennas, modifications or attachments could damage the phone and may violate regulations governing radio devices.

All of the above suggestions apply equally to your phone, battery, charger or any accessory. If any of them is not working properly, take it to your nearest qualified service facility. The personnel there will assist you and, if necessary, arrange for service.

IMPORTANT SAFETY INFORMATION

■ Traffic Safety

Do not use a hand-held telephone while driving a vehicle. Always secure the phone in its holder; do not place the phone on the passenger seat or where it can break loose in a collision or sudden stop.

Remember road safety always comes first!

■ Operating environment

Remember to follow any special regulations in force in any area and always switch off your phone whenever it is forbidden to use it, or when it may cause interference or danger.

Use the phone only in its normal operating positions.

Parts of the phone are magnetic. Metallic materials may be attracted to the phone, and persons with a hearing aid should not hold the phone to the ear with the hearing aid. Always secure the phone in its holder, because metallic materials may be attracted by the earpiece. Do not place credit cards or other magnetic storage media near the phone, because information stored on them may be erased.

■ Electronic devices

Most modern electronic equipment is shielded from radio frequency (RF) signals. However, certain electronic equipment may not be shielded against the RF signals from your wireless phone.

Pacemakers

Pacemaker manufacturers recommend that a minimum separation of 20 cm be maintained between a handheld wireless phone and a pacemaker to avoid potential interference with the pacemaker. These recommendations are consistent with the independent research by and recommendations of Wireless Technology Research. Persons with pacemakers:

- Should always keep the phone more than 20 cm from their pacemaker when the phone is switched on;
- Should not carry the phone in a breast pocket;
- Should use the ear opposite the pacemaker to minimise the potential for interference.
- If you have any reason to suspect that interference is taking place, switch off your phone immediately.

Hearing aids

Some digital wireless phones may interfere with some hearing aids. In the event of such interference, you may want to consult your service provider.

Other medical devices

Operation of any radio transmitting equipment, including cellular phones, may interfere with the functionality of inadequately protected medical devices. Consult a physician or the manufacturer of the medical device to determine if they are adequately shielded from external RF energy or if you have any questions. Switch off your phone in health care facilities when any regulations posted in these areas instruct you to do so. Hospitals or health care facilities may be using equipment that could be sensitive to external RF energy.

Vehicles

RF signals may affect improperly installed or inadequately shielded electronic systems in motor vehicles (e.g. electronic fuel injection systems, electronic anti-skid (anti-lock) braking systems, electronic speed control systems, air-bag systems). Check with the manufacturer or its representative regarding your vehicle. You should also consult the manufacturer of any equipment that has been added to your vehicle.

Posted facilities

Switch your phone off in any facility where posted notices so require.

■ Potentially explosive atmospheres

Switch off your phone when in any area with a potentially explosive atmosphere and obey all signs and instructions. Sparks in such areas could cause an explosion or fire resulting in bodily injury or even death.

Users are advised to switch off the phone when at a refuelling point (service station). Users are reminded of the need to observe restrictions on the use of radio equipment in fuel depots (fuel storage and distribution areas), chemical plants or where blasting operations are in progress.

Areas with a potentially explosive atmosphere are often but not always clearly marked. They include below deck on boats; chemical transfer or storage facilities; vehicles using liquified petroleum gas (such as propane or butane); areas where the air contains chemicals or particles, such as grain, dust or metal powders; and any other area where you would normally be advised to turn off your vehicle engine.

■ Vehicles

Only qualified personnel should service the phone, or install the phone in a vehicle. Faulty installation or service may be dangerous and may invalidate any warranty which may apply to the unit.

Check regularly that all wireless phone equipment in your vehicle is mounted and operating properly.

Do not store or carry flammable liquids, gases or explosive materials in the same compartment as the phone, its parts or accessories.

For vehicles equipped with an air bag, remember that an air bag inflates with great force. Do not place objects, including both installed or portable wireless equipment in the area over the air bag or in the air bag deployment area. If in-vehicle wireless equipment is improperly installed and the air bag inflates, serious injury could result.

Using your phone while in the air is prohibited. Switch off your phone before boarding an aircraft. The use of wireless telephones in an aircraft may be dangerous to the operation of the aircraft, disrupt the wireless telephone network and may be illegal.

Failure to observe these instructions may lead to suspension or denial of telephone services to the offender, or legal action or both.



■ Emergency calls



Important: This phone, like any wireless phone, operates using radio signals, wireless and landline networks as well as user-programmed functions. Because of this, connections in all conditions can not be guaranteed. Therefore, you should never rely solely upon any wireless phone for essential communications (e.g. medical emergencies).

Emergency calls may not be possible on all wireless phone networks or when certain network services and/or phone features are in use. Check with local service providers.

To make an emergency call:

1. If the phone is not on, switch it on. Check for adequate signal strength.
Some networks may require that a valid SIM card is properly inserted in the phone.
2. Press  as many times as needed (e.g. to exit a call, to exit a menu, etc.) to clear the display and ready the phone for calls.
3. Key in the emergency number for your present location (e.g. 112 or other official emergency number).
Emergency numbers vary by location.
4. Press the  key

If certain features are in use, you may first need to turn those features off before you can make an emergency call. Consult this guide and your local cellular service provider.

When making an emergency call, remember to give all the necessary information as accurately as possible. Remember that your wireless phone may be the only means of communication at the scene of an accident - do not cut off the call until given permission to do so.

■ Certification information (SAR)

THIS MODEL PHONE MEETS THE EU REQUIREMENTS FOR EXPOSURE TO RADIO WAVES.

Your mobile phone is a radio transmitter and receiver. It is designed and manufactured not to exceed the limits for exposure to radiofrequency (RF) energy recommended by The Council of the European Union. These limits are part of comprehensive guidelines and establish permitted levels of RF energy for the general population. The guidelines were developed by independent scientific organisations through periodic and thorough evaluation of scientific studies. The limits include a substantial safety margin designed to assure the safety of all persons, regardless of age and health.

The exposure standard for mobile phones employs a unit of measurement known as the Specific Absorption Rate, or SAR. The SAR limit recommended by The Council of the European Union is 2.0 W/kg.* Tests for SAR have been conducted using standard operating positions with the phone transmitting at its highest certified power level in all tested frequency bands. Although the SAR is determined at the highest certified power level, the actual SAR level of the phone while operating can be well below the maximum value. This is because the phone is designed to operate at multiple power levels so as to use only the power required to reach the network. In general, the closer you are to a base station antenna, the lower the power output.

Before a phone model is available for sale to the public, compliance with the European R&TTE directive must be shown. This directive includes as one essential requirement the protection of the health and the safety for the user and any other person. The highest SAR value for this model phone when tested for compliance against the standard was 0.82 W/kg. While there may be differences between the SAR levels of various phones and at various positions, they all meet the EU requirements for RF exposure.

* The SAR limit for mobile phones used by the public is 2.0 watts/kilogram (W/kg) averaged over ten grams of tissue. The limit incorporates a substantial margin of safety to give additional protection for the public and to account for any variations in measurements. SAR values may vary depending on national reporting requirements and the network band. For SAR information in other regions please look under product information at www.nokia.com.

LIMITED MANUFACTURER'S WARRANTY

PART OF EUROPE & AFRICA REGION

This limited warranty shall apply in part of Nokia Mobile Phones' Europe & Africa Region unless a local warranty exists. Nokia Corporation, Nokia Mobile Phones ("Nokia") warrants that this NOKIA product ("Product") is at the time of its original purchase free of defects in materials, design and workmanship subject to the following terms and conditions:

1. This limited warranty is given to the end-purchaser of the Product ("Customer"). It shall neither exclude nor limit i) any mandatory statutory rights of the Customer or ii) any of the Customer's rights against the seller/dealer of the Product.
2. The warranty period is twelve (12) months from the date on which the first Customer purchased the Product. In case of a subsequent purchase or other change of owner/user, such warranty period shall continue for the remaining part of the twelve (12) month period and otherwise remain unaffected. This limited warranty is only valid and enforceable in the following countries: Bosnia, Bulgaria, Croatia, Cyprus, the Czech Republic, Estonia, any member state of the European Union, Hungary, Iceland, Israel, Latvia, Lithuania, Macedonia, Malta, Norway, Poland, Romania, the Slovak Republic, Slovenia, Switzerland and Turkey.
3. During the warranty period Nokia or its authorized service company will repair or replace, at Nokia's sole discretion, a defective Product. Nokia will return the repaired Product or another Product to the Customer in good working condition. All parts or other equipment for which replacements have been provided shall become the property of Nokia.
4. A repaired or replaced Product will not be given a prolonged or renewed warranty period.
5. This limited warranty will not cover painted covers or other similar personalized parts. In all cases that require unlocking or locking of an operator SIM-lock, Nokia will first direct the Customer to such operator for unlocking or locking of the operator SIM-lock before repairing or replacing the Product.
6. This limited warranty shall not apply to deterioration due to normal wear and tear. This limited warranty shall further not apply if:

(i) the defect was caused by the fact that the Product has been subjected to: use in contradiction with the owner's/user manual, rough handling, exposure to moisture, dampness or extreme thermal or environmental conditions or rapid changes in such conditions, corrosion, oxidation, unauthorized modifications or connections, unauthorized opening or repair, repair by use of unauthorized spare parts, misuse, improper installation, accident, forces of nature, spillage of food or liquid, influence from chemical products or other acts beyond the reasonable control of Nokia (including but not limited to deficiencies in consumable parts, such as batteries

which all by their nature have a limited lifetime, and breakage or damage to antennas) unless the defect was caused directly by defects in materials, design or workmanship;

- (ii) Nokia or its authorized service company was not notified by the Customer of the defect within thirty (30) days after the appearance of the defect within the warranty period;
 - (iii) the Product was not returned to Nokia or its authorized service company within thirty (30) days after the appearance of the defect within the warranty period;
 - (iv) the Product serial number, the accessory date code or the IMEI number has been removed, erased, defaced, altered or is illegible;
 - (v) the defect was caused by a defective function of the cellular network;
 - (vi) the defect was caused by the fact that the Product was used with or connected to an accessory not manufactured and supplied by Nokia or used in other than its intended use;
 - (vii) the defect was caused by the fact that the battery was short-circuited or seals of the battery enclosure or cells were broken or show evidence of tampering or the battery was used in equipment other than for which it has been specified; or
 - (viii) the Product software needs to be upgraded due to changes in cellular network parameters.
7. To claim this limited warranty the Customer shall present either i) a legible and non-modified original warranty card which clearly indicates the name and address of the seller, the date and place of purchase, the product type and the IMEI or other serial number or alternatively ii) a legible and non-modified original purchase receipt which contains the same information, if such purchase receipt is presented to the seller/dealer of the Product.
 8. This limited warranty is the Customer's sole and exclusive remedy against Nokia and Nokia's sole and exclusive liability against the Customer for defects or malfunctions of the Product. This limited warranty replaces all other warranties and liabilities, whether oral, written, (non-mandatory) statutory, contractual, in tort or otherwise. Nokia is in no event liable for any incidental, consequential or indirect damage, costs or expenses. Neither is Nokia in any event liable for any direct damage, costs or expenses, if the Customer is a legal person.
 9. Any change or amendment to this limited warranty requires Nokia's prior written consent.

